

Model	Other model names	Date	Revision	Revision date
FX Handpump		2018-06-18	EN.20.02	2020-03-23

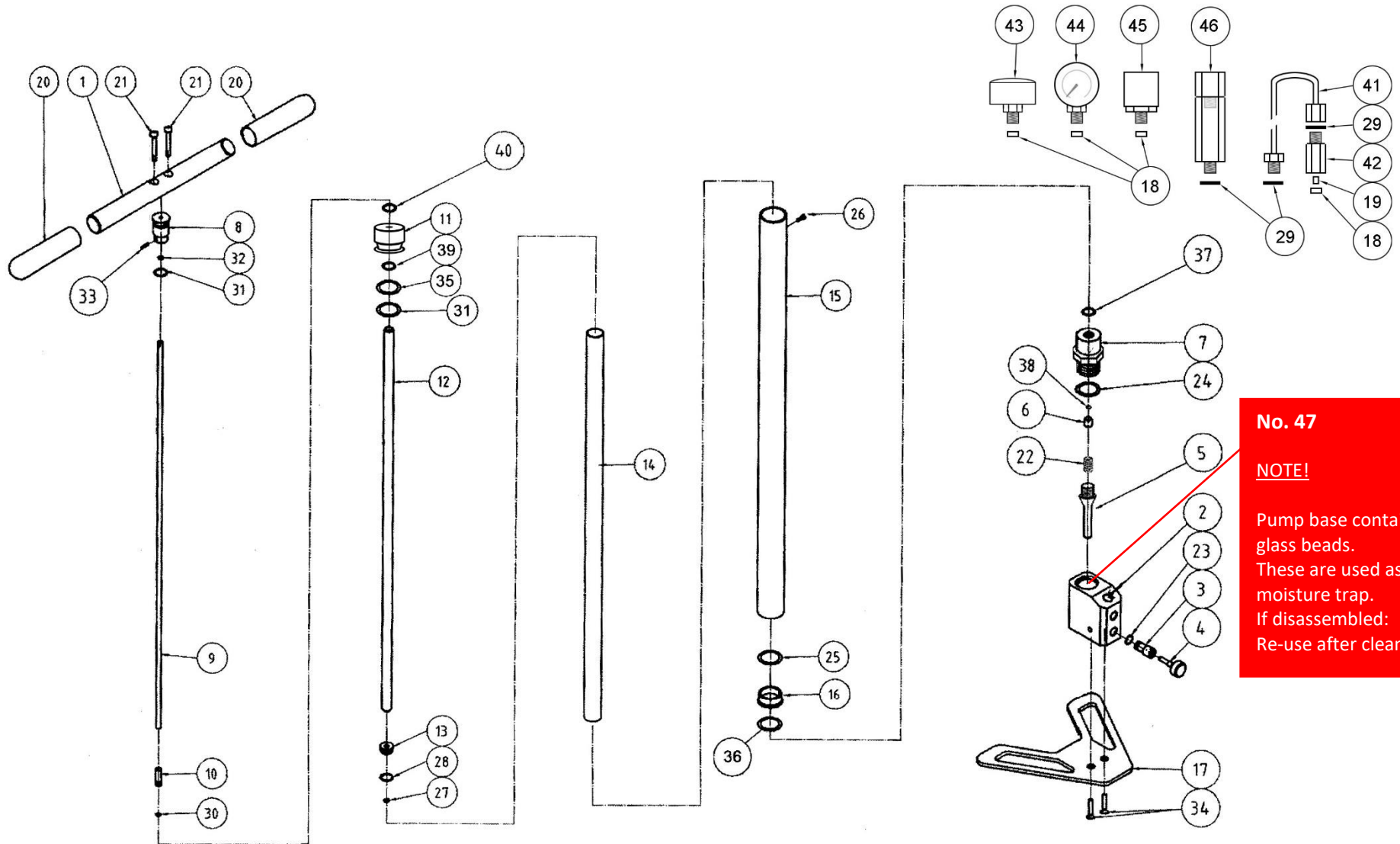

**No. 47**  
**NOTE!**  
 Pump base contains glass beads. These are used as a moisture trap. If disassembled: Re-use after cleaning.

Model	Other model names	Date	Revision	Revision date
FX Handpump		2018-06-18	EN.20.02	2020-03-23

NO	ART. NO	DESCRIPTION	NO	ART. NO	DESCRIPTION
1	1010	Handlebar 3stage Pump	30	5107	O-ring 2.9x1.78 PUR90
2	1005	Pump base	31	5101	O-ring 20x2.5 NBR70
3	5002	Valve shell	32	5110	Rubber ball 4.75 NBR70
4	5004	Valve screw	33	1501	Cylindrical pin 2,5m6x24
5	5009	Valve pipe	34	5203	Screw M5x10
6	5000	Inlet valve pump	35	5113	O-ring 20.24x2.62 NBR70
7	5012	Main valve housing	36	5106	O-ring 21.4x2.4 NBR70
8	1008	Inlet valve housing	37	5105	O-ring 9.3x2.4 NBR90
9	1009	Bar 5mm	38	5111	O-ring 2.5x1.5 NBR90
10	1004	High pressure piston	39	1504	O-ring 4.42x2.62 NBR70
11	1003	Large piston	40	5112	O-ring 5.28x1.78 NBR70 ( <i>free floating</i> )
12	1001	Tube 10mm	41	5403	Kevlar hose
13	5001	Brass cap	42	5008	Particlefilter assembly
14	1002	Inner tube 22mm	43	5401	Manometer Rear Connection 1/8" 300bar
15	1012	Outer tube 28mm	44	5400	Manometer Side Connection 1/8" 300bar
16	1000	Threaded brass cap	45	5007	Adapter 1/8" external > internal DIN
17	1011	Footplate	46	0150	External moisture trap
18	5003	Plastic Washer 4mm 1/8"			
19	1014	Cleaning pellets .177 100-p	47	5402	Glass Beads (approximately 12 gram)
20	1503	Rubber handle FX Pump			
21	1017	Countersunk screw M5x25			
22	5204	Spring 0.5x3x15			
23	5005	Plastic washer 2mm			
24	5103	O-ring 18x2.5 NBR90, <b>until September 2017</b>			
24	5115	O-ring 17,2 x 3,0 NBR 70, <b>Block marked V2</b>			
25	5100	O-ring 23x1 NBR90 ( <i>free floating</i> )			
26	5200	Button head screw M4x6			
27	5104	O-ring 9.3x2.4 NBR70			
28	5109	O-ring 11.6x2.4 NBR70			
29	1511	Washer rubber/steel 1/8"			