

Model	Other model names	Date	Revision	Revision date
FX Monsoon		2018-06-20	EN.20.01	2020-03-31

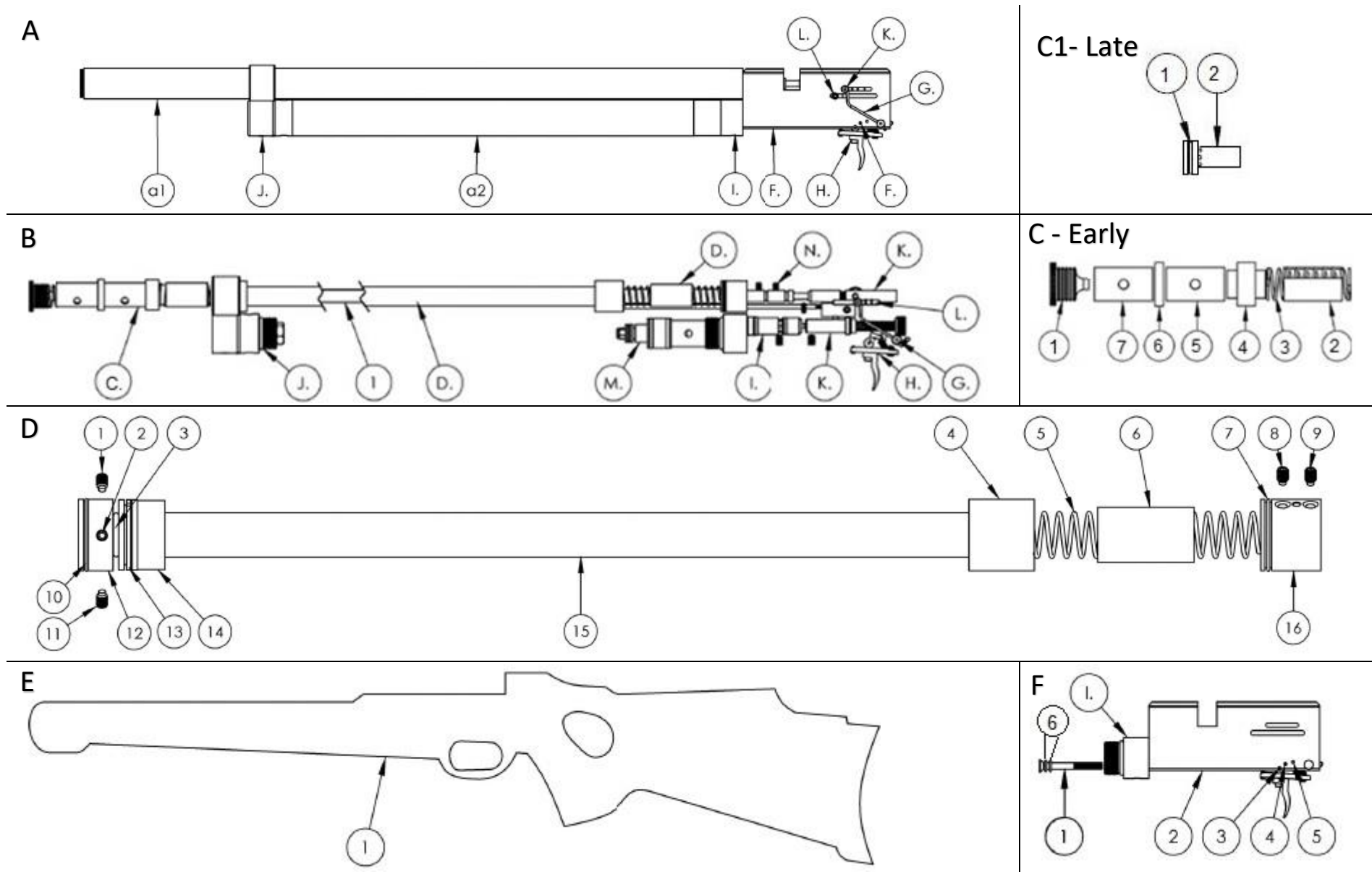

Model	Other model names	Date	Revision	Revision date
FX Monsoon		2018-06-20	EN.20.01	2020-03-31

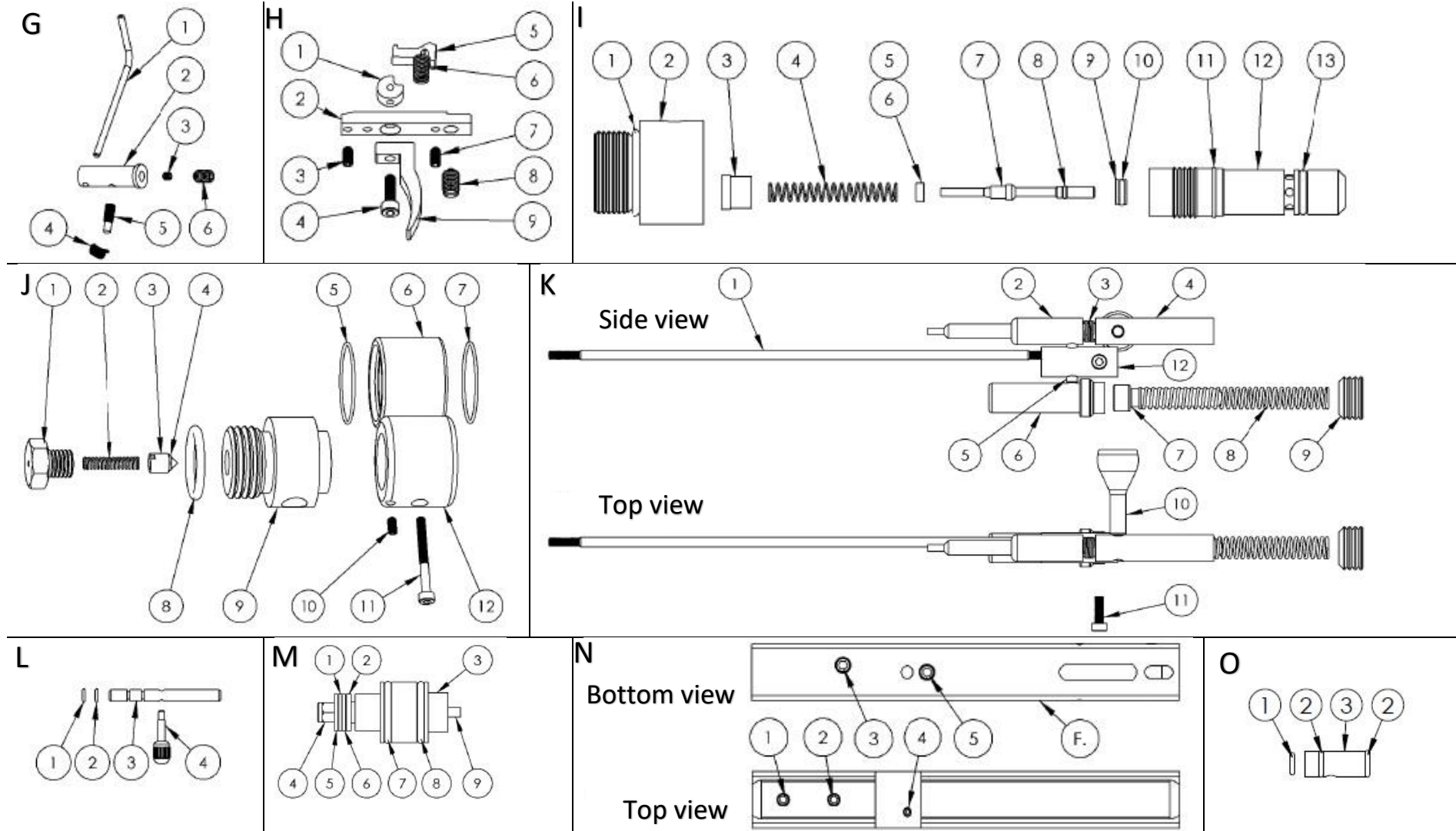

Model	Other model names	Date	Revision	Revision date
FX Monsoon		2018-06-20	EN.20.01	2020-03-31

NO	ART. NO	DESCRIPTION	NO	ART. NO	DESCRIPTION	NO	ART. NO	DESCRIPTION
A1	18025	Tube Outer V6- Monsoon	F5	16023	Cylindrical pin 2h6x16	J10	2637	Grub screw M4x6 flat
A2 - 4,5	16017-4,5	Airtube 390 (drilled)	F6	5112	O-ring 5,28x1,78 NBR70	J11	11506	Socket head cap screw M3x30
A2 - 5,5	16017	Airtube 390	F7	16023	Steel pin 2x16	J12	12036	Barrel support base
B1 - 4,5	18048	4,50 -12 - 485	G1	18045	Reset pin v6	K1	18035	Reloading rod
B1 - 5,5	2629	Barrel 5,50-12-485	G2	18002	Reset axle V6	K2 - 4,5	18006	Pellet probe .177 v6
C1 - 4,5	17023	Muzzle .177	G3	12035	Grub screw M2,5x2,5	K2 - 5,5	18007	Pellet probe .22
C1 - 5,5	17000	Muzzle .22	G4	17018	Spring 0,2x3x15	K3	18044	Rotating spring
C2	18023	Plastic pipe short	G5	17040	Reset screw M3	K4	18008	Bolt attachment
C3	18033	Spring 1,5x16x65	G6	2637	Grub screw M4x6 flat	K5	18039	Cylindrical pin 4h6x24
C4 - 4,5	18022	Spring guide .22	H1	11525	Trigger Wheel	K6	18047	Hammer Semi-Auto*
C4 - 5,5	18021	Spring guide .177	H2	17017	Trigger base v4.6	K7 - 4,5	18029	Hammerweight .177
C5	18023	Plastic pipe short	H3	2500	Grub screw M3x6	K7 - 5,5	18030	Hammerweight .22
C6 - 4,5	10837	Washer Reloading .177	H4	2527	Socket head cap screw M3x10	K8	18038	Hammerspring Monsoon
C6 - 5,5	18040	Washer reloading .22	H5	18009	Trigger Sear Monsoon*	K9	17006	Spring guide
C7	18023	Plastic pipe short	H6	17046	Spring 0,5x3,5x15	K10	18004	Cocking bolt
			H7	2500	Grub screw M3x6	K11	2527	Socket head cap screw M3x10
C1-1	19028	Shroud compensator 4,5-5,5	H8	11015	Second stage trigger screw M5	K12	18005	Probe and hammer aligner
C1-2	19098	O-ring 18,0x4,0 NBR 70	H9	2020	Trigger blade	L1	2528	O-ring 1,5x1 NBR70
						L2	2528	O-ring 1,5x1 NBR70
			I1	11624	O-ring 22x2,5 NBR70	L3	18003	Safety rod
D1	2534	Conical grub screw M5x6	I2	18017	Valve offset	L4	2035	Magazine Pin Handle
D2	2534	Conical grub screw M5x6	I3	18037	Valve spring lid 5,5	M - 4,5	15017	Regulator for 33mm tube
D3	5109	O-ring 11,6x2,4 NBR 70	I4	16030	Spring 0,5x5x40	N1,2	2501	Cup point grub screw M4x6
D4	18016	Brass bushing	I5	2040	Plastic Washer	N3	2503	Cup point grub screw M5x8
D5	18019	Spring 1,25x16x137 (for reloading)	I6	2041	Holder Valve Seal	N4	-	Empty Hole
D6	18024-2	Plastic 16 Pipe Short	I7	7034	Valve pin complete V1,3,6	N5		Stock Screw
D7	5100	O-ring 23x1 NBR90	I8	2528	O-ring 1,5x1 NBR70			
D8	2534	Conical grub screw M5x6	I9	7044	Valve seat Complete	O1 - 4,5	2529	O-ring 4,3x1,5 NBR70
D9	2534	Conical grub screw M5x6	I10	2529	O-ring 4,3x1,5 NBR70	O1 - 5,5	5108	O-ring 5,28x1,78 PUR70
D10	5100	O-ring 23x1 NBR90	I11	16028	O-ring 12x1 NBR70	O2	5112	O-ring 5,28x1,78 NBR70
D11	2534	Screw M5 x 6	I12	18014	Main Valve Housing V6	O3 - 4,5 ST	2057	Barrel brass inlet .177
D12	18013	Brass Air Bushing	I13	5104	O-ring 9,3x2,4 NBR70	O3 - 5,5 ST	2056	Barrel Inlet .22
D13	18028	Piston Ring						
D14	18015	Reloading Piston	J1	11017	Air tube end Inlet Nut			
D15	18024	Plastic pipe long	J2	2524	Spring 0,4x3x20			
D16	18012	Steel bushing	J3	12011	Inlet valve			
E1	-	Stock	J4	5111	O-ring 2,5x1,5 NBR90			
F1	18034	Countersunk screw M6x45	J5	18031	O-ring 28x1 NBR70			
F2	18000	Barrel housing 4,5	J6	18018	Barrel support ring			
F2	18001	Barrelhousing Monsoon	J7	18031	O-ring 28x1 NBR70			
F3	16023	Cylindrical pin 2h6x16	J8	11624	O-ring 22x2,5 NBR70			
F4	17035	Pianowire / Trigger Semi-Auto	J9	11029	Air Cylinder End Inlet			