

Model	Other model names	Date	Revision	Revision date
FX Handpump, 4stage Turbo edition		2018-06-19	EN.20.2	2020-10-12

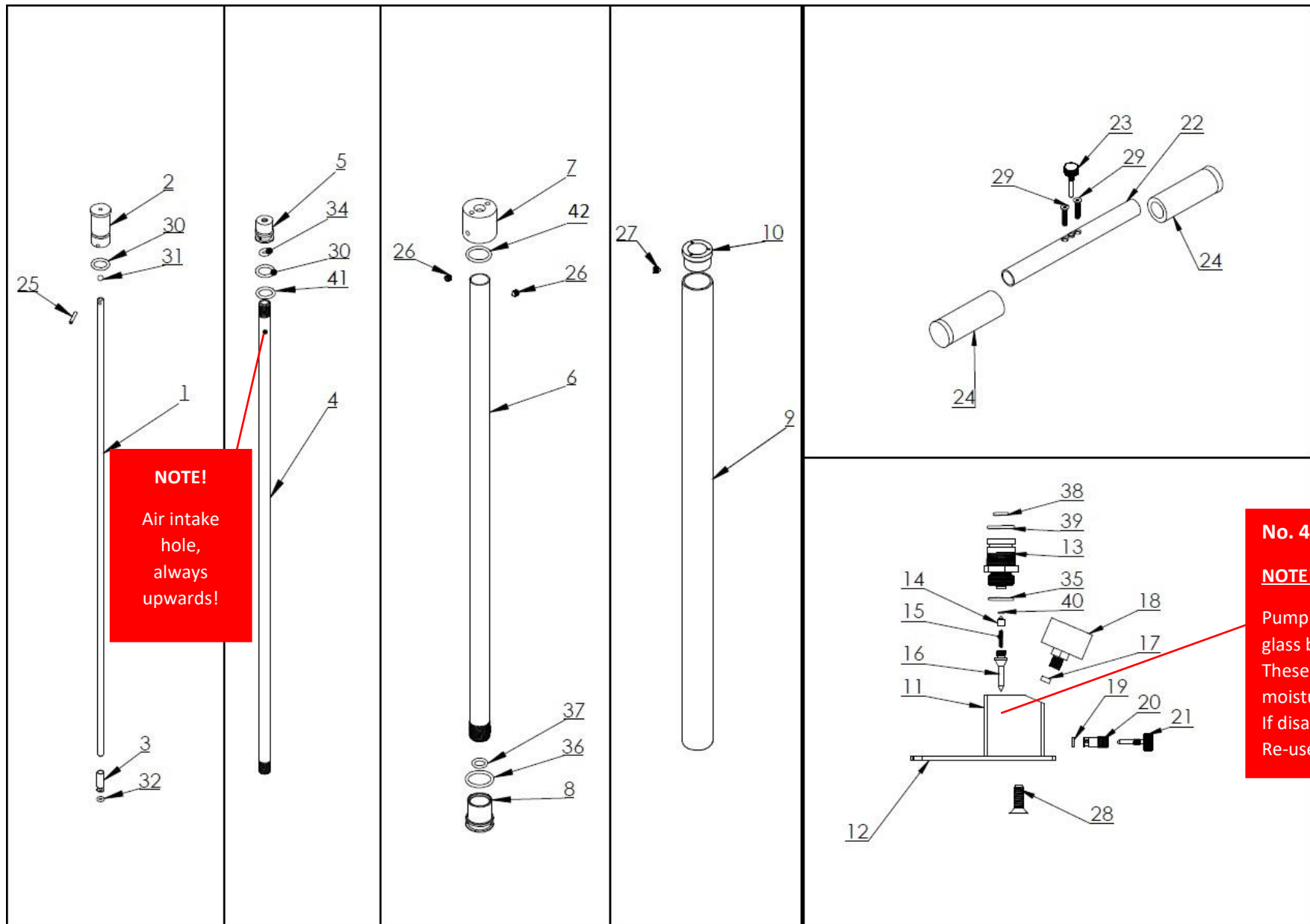

**NOTE!**  
Air intake hole, always upwards!

**No. 47**  
**NOTE!**  
Pump base contains glass beads. These are used as a moisture trap. If disassembled: Re-use after cleaning.

Model	Other model names	Date	Revision	Revision date
FX Handpump, 4stage Turbo edition		2018-06-19	EN.20.2	2020-10-12

NO	ART. NO	DESCRIPTION	NO	ART. NO	DESCRIPTION
1	1009	Bar 5mm	29	1017	Countersunk screw M5x25
2	3002	Inlet valve head	30	5109	O-ring 11,6 x 2,4 NBR70
3	1004	High pressure piston	31	5110	Rubberball 4,75 NBR70
4	1001	Tube 10mm	32	5107	O-ring 2,9 x 1,78 PUR90
5	3006	Middle piston			
6	3009	Tube 18mm	34	1504	O-ring 4,42 x 2,62 NBR70
7	3000	Handlemount	35	5103	O-ring 18,0 x 2,5 NBR90, <i>until September 2017</i>
8	3004	Big piston	35	5115	O-ring 17,2 x 3,0 NBR 70, <b>Block marked V2</b>
9	1012	Outer Tube 28mm	36	5113	O-ring 20,24 x 2,62 NBR 70
10	3003	Plastic bushing	37	5104	O-ring 9,3 x 2,4 NBR70
11	1005	Pump base	38	5105	O-ring 9,3 x 2,4 NBR90
12	1011	Footplate	39	5101	O-ring 20,0 x 2,5 NBR70
13	3005	Main valve housing	40	5111	O-ring 2,5 x 1,5 NBR90
	3013	Main valve housing complete with o-rings and internal parts	41	16028	O-ring 12,0 x 1,0 NBR 70 (free floating)
14	5000	Inlet valve pump	42	5103	O-ring 18,0 x 2,5 NBR90 (free floating)
	7049	Back valve complete for pump			
15	5204	Spring 0,5x3x15	47	5402	Glass Beads (approximately 12 gram)
16	5009	Valve pipe			
17	5003	Plastic Washer 4mm 1/8"			
18	5401	Manometer Rear Connection 1/8" 300bar			
	5400	Manometer Side/Bottom Connection 1/8"			
19	5005	Plastic Washer 2mm 1/8"			
20	5002	Valve shell			
21	5004	Valve Screw			
22	3008	Handelbar turbo pump			
23	3001	Valve Screw long 4			
24	1503	Rubber handle FX Pump			
25	3010	Cylindric pin 2,5x16			
26	2534	Conical grub screw M5x6			
27	3007	Grubscrew M4x4			
28	5203	Countersink M5x10			